

**NOTES:**

- ① THIS CONNECTOR IS DESIGNED TO MEET THE APPLICABLE PERFORMANCE REQUIREMENTS OF IEC 61076-4-101 AND BELLCORE GR-1217-CORE
- 2 RoHS DIRECTIVE COMPLIANCE, MAX SOLDERING TEMPERATURE 225°C.
- 3 CONNECTORS ARE END STACKABLE ON A 2.0 GRID.
- 4 FOR COMPLIANT CONTACT PLATED THRU HOLE REQUIREMENTS SEE THRU HOLE PLATING VIEW. MINIMUM P.C.BOARD THICKNESS 1.57 NOMINAL.
- 5 OPTIONAL BOTTOM SHIELD SOLD SEPARATELY
- ⑥ NO GAP PERMISSIBLE TO PC BOARD.

SPECIFICATIONS

MATERIALS

- ① Insulators:  
Thermoplastic Polyester, glass filled  
Rated UL 94V-0, Color: Gray
- ② Pin contacts:  
Copper Alloy  
Finish: Mating Zone=Gold  
Compliant Zone=Matte Tin  
Performance Class 2= 250 cycles
- ③ Top Shield:  
Copper Alloy  
Finish: Nickel Plate

PERFORMANCE CHARACTERISTICS ①

Insulation resistance: 10,000 megohms minimum  
 Dielectric withstanding voltage(at sea level): 750 Vrms  
 Current rating: 1 amp @70°C, fully loaded  
 1.5 amp @20°C, fully loaded  
 Operating temperature range: -55°C to +125°C  
 Contact resistance: 20 milliohms maximum

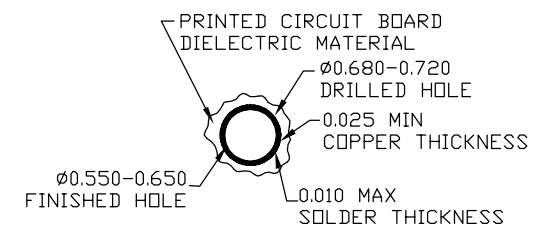
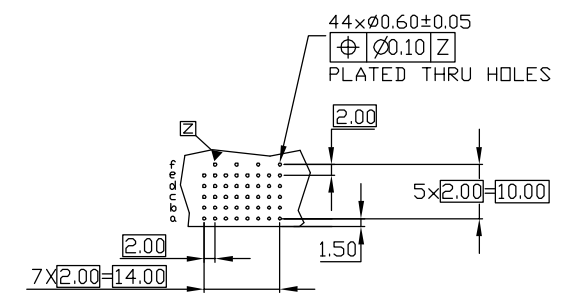
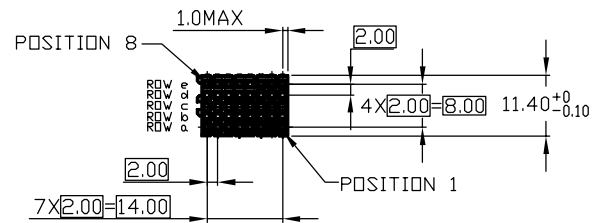
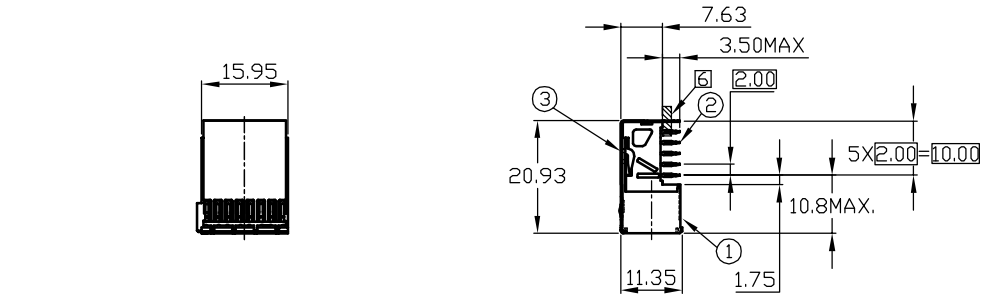

RECOMMENDED PC BOARD REQUIREMENTS  
(COMPONENT SIDE BOARD SHOWN)

THRU HOLE PLATING  
SCALE 10:1

REV.	DESCRIPTION	DATE	APPD
C	ECN-130093	6/13/13	Seawen
B	ECR-NC0265,NC0266	11/30/11	Seawen
A	RELEASE	5/10/10	Seawen

UNITS		NAME: Enriched Hard-Metric Female B8 type ASSY	PART NO: R-814F011A10010	TITLE: CUSTOMER DWG.
<input checked="" type="checkbox"/> mm	<input type="checkbox"/> INCH			
GENERAL TOLERANCES: (UNLESS SPECIFIED)		APPD: 楊海文 6/13/13	CHKD: 廖小瓊 6/13/13	DWG NO: 010-0000-684-814F011A10010
4 PLACE	±0.05 ±.**	DRAWN: 何潔賢 6/13/13	SCALE: 1/1	SHEET: 1/5
3 PLACE	±0.10 ±.**		REV.:	C
2 PLACE	±0.20 ±.**			
1 PLACE	±0.30 ±.**			
ANGULAR:	X°±.** X°±.**			